

LIQUIP

VTE-3

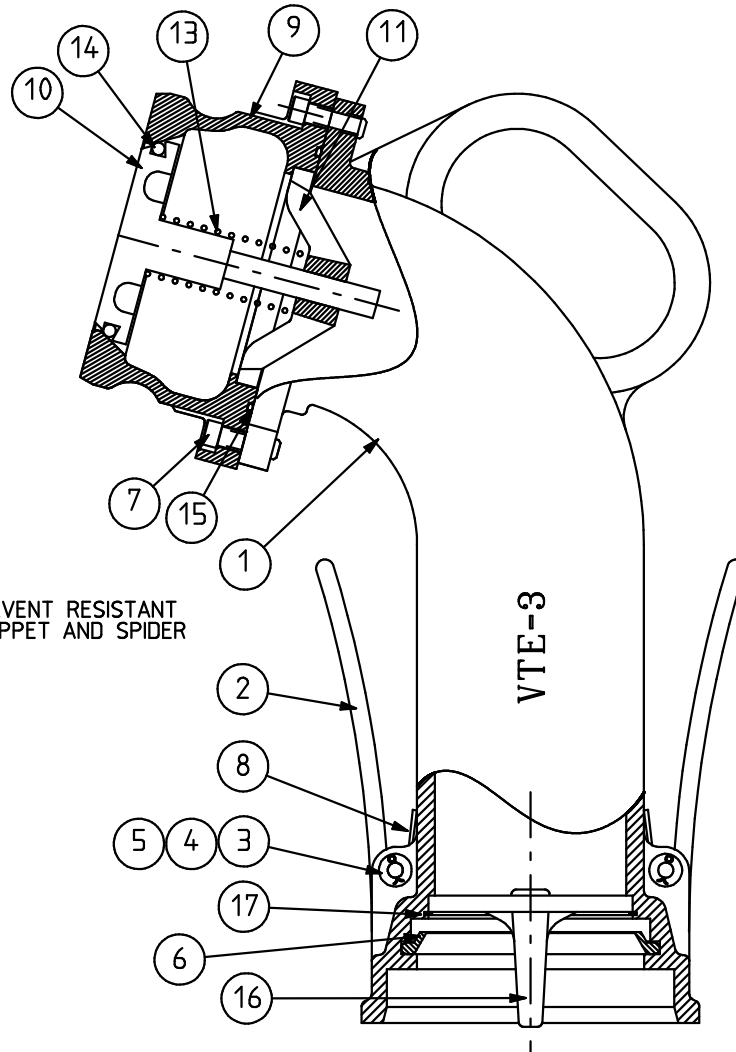

NOTE:
ASSEMBLE USING SOLVENT RESISTANT
GREASE BETWEEN POPPET AND SPIDER

ITEM	PART NO	DESCRIPTION	MATERIAL	QTY
1	VTE3-10	BODY	ALUMINIUM	1
2	LTE4-8	LEVER	BRONZE	2
3	1081	CLEVIS PIN	M/S Z/P	2
4	0100	WASHER	M/S Z/P	2
5	0757	SPLIT PIN	M/S Z/P	2
6	VTE3-7	LIP SEAL	ACRYLONITRILE	1
7	0716	CAPSCREW	M/S Z/P	4
8	LTE4-9	SPRING	M/S Z/P	2
9	VTE3-11	NOSE CONE	ALUMINIUM	1
10	VTE3-12	POPPET	ALUMINIUM	1
11	VTE3-3	SPIDER	ALUMINIUM	1
12				
13	VTE3-4	SPRING	M/S Z/P	1
14	0264	O-RING	VITON	1
15	0265	O-RING	NITRILE	1
16	VTE3-6	PLUNGER	ALUMINIUM	1
17	VTE3-8	CIRCLIP	M/S Z/P	1

X1250796

Issue: B

METERS - VALVES - VENTS - MANHOLES - PUMPS - HOSEREELS - OVERFILL PROTECTION - LOADING ARMS - ELECTRONIC DIPSTICKS

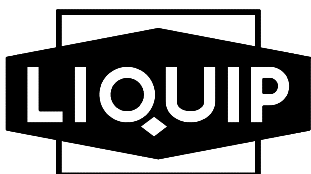

LIQUIP INTERNATIONAL PTY LTD

PO Box 7049
Wetherill Park BC, 2164
Sydney NSW Australia
Phone: +612 9725 9000
Fax: +612 9725 1252

DISTRIBUTORS

See website
for Liquip branches
and Distributors

www.liquip.com